

M18BOS125-502B BTY. ORBITAL SANDER IN2

4933464229 - M18BOS125B-502 - 4000467519

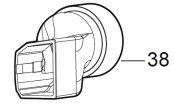

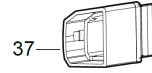
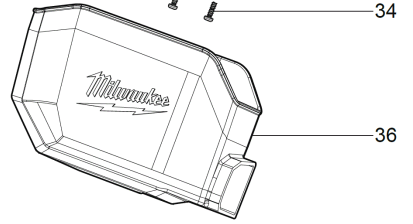
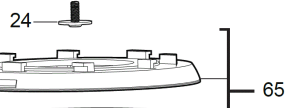
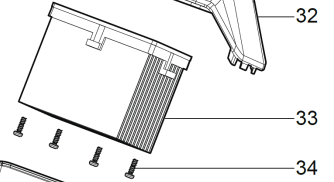
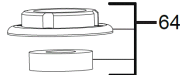
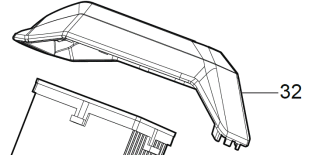
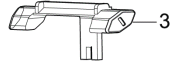
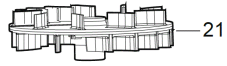
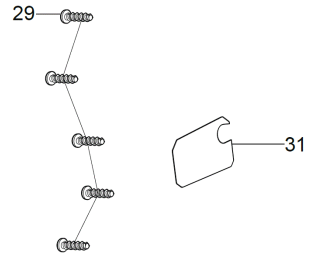
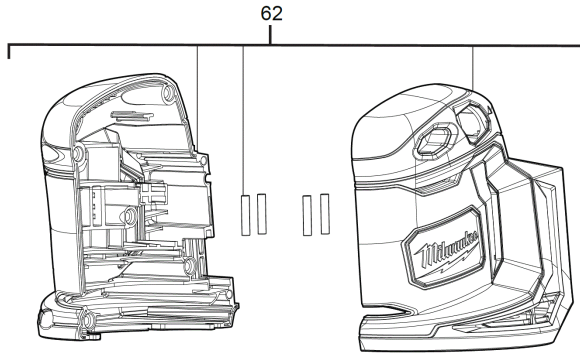
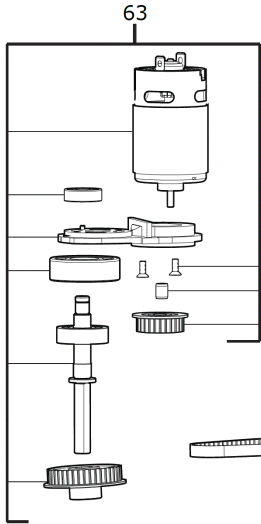
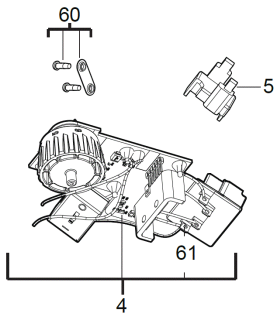

Position	Quantity	Description	Part number	EAN
0003	1	SWITCH LEVER	4931465600	4058546237004
0004	1	ELECTRONIC	4931465601	4058546237011
0005	1	HOLDER	4931465602	4058546237028
0006	1	PRESSURE SPRING	4931408243	4002395814466
0019	1	STRAP	4931465603	4058546237035
0021	1	BALANCE WEIGHT	4931465604	4058546237042
0024	1	SCREW	4931465605	4058546237059
0029	5	SCREW	4931465606	4058546237066
0031	1	RATING PLATE	4931465607	4058546237073
0032	1	PROTECTIVE CAP	4931465608	4058546237080
0033	1	PAPER FILTER	4931465609	4058546237097
0034	4	SCREW	4931465610	4058546237103
0036	1	TANK	4931465611	4058546237110
0037	1	EXTENSION	4931465612	4058546237127
0038	1	ADAPTOR	4931465613	4058546237134
0060	1	HOLDING PLATE	4931465614	4058546237141
0061	1	TERMINAL STRIP	302119005	4002395856152
0062	1	HOUSING	4931465615	4058546237158
0063	1	MOTOR ASSEMBLY	4931465616	4058546237165
0064	1	BALL BEARING	4931465617	4058546237172
0065	1	ROS125E SANDING PAD BASE PLATE	4932430091	4002395377527